

ES-0804C-M12

12 Port M12 Industrial Unmanaged Gigabit Ethernet Switch



- Compliant with EN50155
- 8x 10/100T(x) M12 connector
- 4x 10/100/1000T(x) M12 connector with relay bypass
- Support Bypass function for non-stop communication even when no power exists
- Built for harsh environments and wide temperature range application
- IP40/IP54(Optional) housing



Specifications

Technology

| | |
|-----------|---|
| Standards | IEEE 802.3 10BaseT IEEE 802.3u 100BaseTX IEEE 802.3ab 1000BaseT |
|-----------|---|

| | |
|-----------------|-------------------|
| Processing Type | Store and Forward |
|-----------------|-------------------|

Switch Properties

| | |
|---------------|---------|
| Switch Fabric | 9.6Gbps |
|---------------|---------|

| | |
|-----------------|---|
| Priority Queues | - |
|-----------------|---|

| | |
|----------------|----|
| MAC Table Size | 8K |
|----------------|----|

| | |
|---------------|--------|
| Packet Buffer | 4Mbits |
|---------------|--------|

Interface

| | |
|-------------------|---|
| Network Connector | 8x 10/100T(x) M12 Female D-coded 4-pole, 4x 10/100/1000T(x) M12 Female X-coded 8-pole, auto negotiation speed duplex mode, auto MDI/MDI-X |
|-------------------|---|

| | |
|----------------|--|
| LED Indicators | Per unit: PWR1, PWR2, Status Ports: Link/Active |
|----------------|--|

Power Requirements

| | |
|-------------------|--|
| Operation Voltage | LV: 24-48VDC, HV: 72-110VDC, redundant dual inputs |
|-------------------|--|

| | |
|------------|-------------------------|
| Connection | M12 Male S-coded 4-pole |
|------------|-------------------------|

| | |
|-------------------|-----|
| Power Consumption | 15W |
|-------------------|-----|

| | |
|------------|--|
| Protection | Overload Current Protected, Reverse Polarity Protected |
|------------|--|

Mechanical Construction

| | |
|-----------|------|
| Enclosure | SECC |
|-----------|------|

| | |
|------------------|---------------------|
| Protection Class | IP40/IP54(Optional) |
|------------------|---------------------|

| | |
|------------|----------------------|
| Dimensions | 181x99x94 mm (WxHxD) |
|------------|----------------------|

| | |
|--------|---------|
| Weight | 1.20 kg |
|--------|---------|

| | |
|----------|--|
| Mounting | Wall Mounting Kits, Optional DIN-Rail Mounting |
|----------|--|

Environmental Limits

| | |
|-----------------------|--|
| Operating Temperature | Extended: -40°C ~ 75°C (-40°F ~ 167°F) |
|-----------------------|--|

| | |
|---------------------|------------------------------|
| Storage Temperature | -40°C ~ 85°C (-40°F ~ 185°F) |
|---------------------|------------------------------|

| | |
|---------------------------|----------------------------|
| Ambient Relative Humidity | 5 to 95%, (Non-Condensing) |
|---------------------------|----------------------------|

Regulatory Approvals

| | |
|-----|--|
| EMI | FCC Part 15 Subpart B Class A CE EN 55032 Class A |
|-----|--|

| | |
|-----|---|
| EMS | IEC61000-4-2 (ESD) IEC61000-4-3 (RS) IEC61000-4-4 (EFT) IEC61000-4-5 (Surge) IEC61000-4-6 (CS) IEC61000-4-8 (Magnetic Field) |
|-----|---|

| | |
|-----------|----------------|
| Free Fall | IEC60068-2-32 |
| Shock | IEC61373 |
| Vibration | IEC61373 |
| Green | RoHS Compliant |

| | |
|----------------|------------------------|
| Certifications | EN 50155 EN 45545-2 |
| MTBF | >100,000 hours |
| Warranty | 5 Years |

Features with star(*) implies those are under development.
In a continuing effort of improvement and updated technology, product specifications are subject to change without notice.

Dimensions (unit = mm)

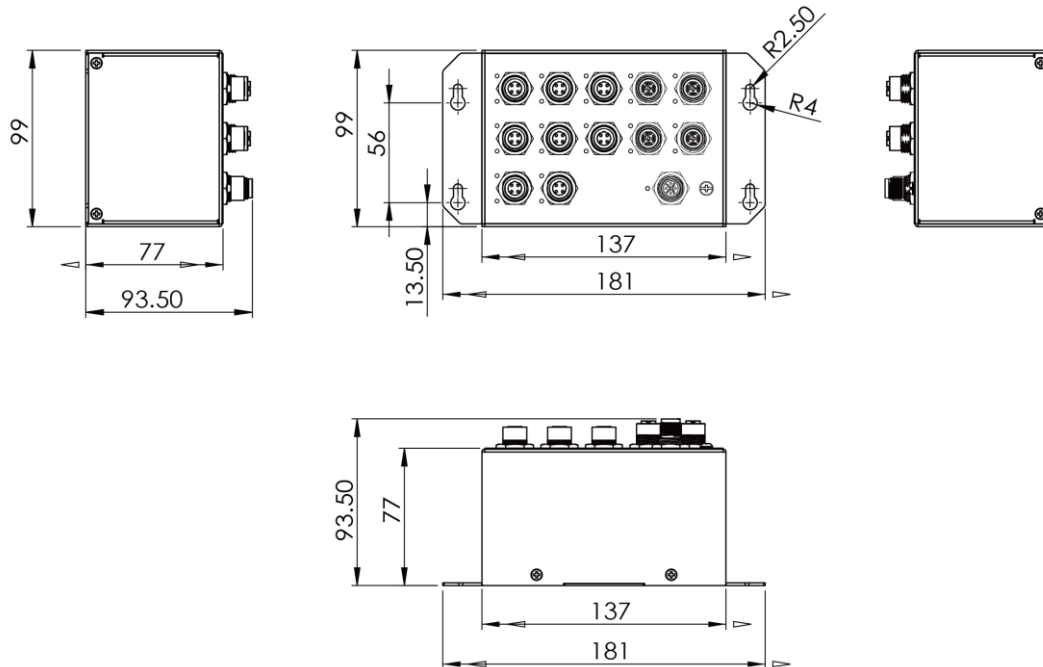

Ordering Information

| | |
|---------------------|---|
| ES-0804C-M12-LVU-T | <p>12 Port M12 Industrial Unmanaged Gigabit Ethernet Switch</p> <ul style="list-style-type: none"> - 8x 10/100T(x) + 4x 10/100/1000T(x) M12 connector - Power Input: 24-48VDC - Operating Temperature: -40°C ~ 75°C (-40°F ~ 167°F) - Protection Class: IP40 - UL Compliant |
| ES-0804C-M12-LVU-WT | <p>12 Port M12 Industrial Unmanaged Gigabit Ethernet Switch</p> <ul style="list-style-type: none"> - 8x 10/100T(x) + 4x 10/100/1000T(x) M12 connector - Power Input: 24-48VDC - Operating Temperature: -40°C ~ 75°C (-40°F ~ 167°F) - Protection Class: IP54 - UL Compliant |
| ES-0804C-M12-HVU-T | <p>12 Port M12 Industrial Unmanaged Gigabit Ethernet Switch</p> <ul style="list-style-type: none"> - 8x 10/100T(x) + 4x 10/100/1000T(x) M12 connector - Power Input: 72-110VDC - Operating Temperature: -40°C ~ 75°C (-40°F ~ 167°F) - Protection Class: IP40 - UL Compliant |
| ES-0804C-M12-HVU-WT | <p>12 Port M12 Industrial Unmanaged Gigabit Ethernet Switch</p> <ul style="list-style-type: none"> - 8x 10/100T(x) + 4x 10/100/1000T(x) M12 connector - Power Input: 72-110VDC - Operating Temperature: -40°C ~ 75°C (-40°F ~ 167°F) - Protection Class: IP54 - UL Compliant |