

ES-0800L-M12

8 Port M12 Industrial Unmanaged Ethernet Switch



- Compliant with EN50155
- 8x 10/100T(x) M12 connector
- Built for harsh environments and wide temperature range application
- IP40/IP54(Optional) housing



Specifications

Technology

Standards IEEE 802.3 10BaseT
IEEE 802.3u 100BaseTX

Processing Type Store and Forward

Switch Properties

Switch Fabric 1.6Gbps

Priority Queues -

MAC Table Size 8K

Packet Buffer 4Mbits

Interface

Network Connector 8x 10/100T(x) M12 Female D-coded 4-pole, auto negotiation speed duplex mode, auto MDI/MDI-X

LED Indicators **Per unit:** PWR1, PWR2, Status
Ports: Link/Active with highest speed(Green), low speed(Amber)

Power Requirements

Operation Voltage 12-48VDC, redundant dual inputs

Connection M12 Male S-coded 4-pole

Power Consumption 15W

Protection Overload Current Protected, Reverse Polarity Protected

Mechanical Construction

Enclosure SECC

Protection Class IP40/IP54(Optional)

Dimensions 181x99x94 mm (WxHxD)

Weight 1.52 kg

Mounting Wall Mounting Kits, Optional DIN-Rail Mounting

Environmental Limits

Operating Temperature Extended: -40°C ~ 75°C (-40°F ~ 167°F)

Storage Temperature -40°C ~ 85°C (-40°F ~ 185°F)

Ambient Relative Humidity 5 to 95%, (Non-Condensing)

Regulatory Approvals

EMI FCC Part 15 Subpart B Class A
CE EN 55032 Class A

EMS IEC61000-4-2 (ESD)
IEC61000-4-3 (RS)
IEC61000-4-4 (EFT)
IEC61000-4-5 (Surge)
IEC61000-4-6 (CS)
IEC61000-4-8 (Magnetic Field)

Free Fall IEC60068-2-32

Shock IEC61373

Green	RoHS Compliant	MTBF	>100,000 hours
Certifications	EN 50155 EN 45545-2	Warranty	5 Years

Features with star(*) implies those are under development.
In a continuing effort of improvement and updated technology, product specifications are subject to change without notice.

Dimensions (unit = mm)

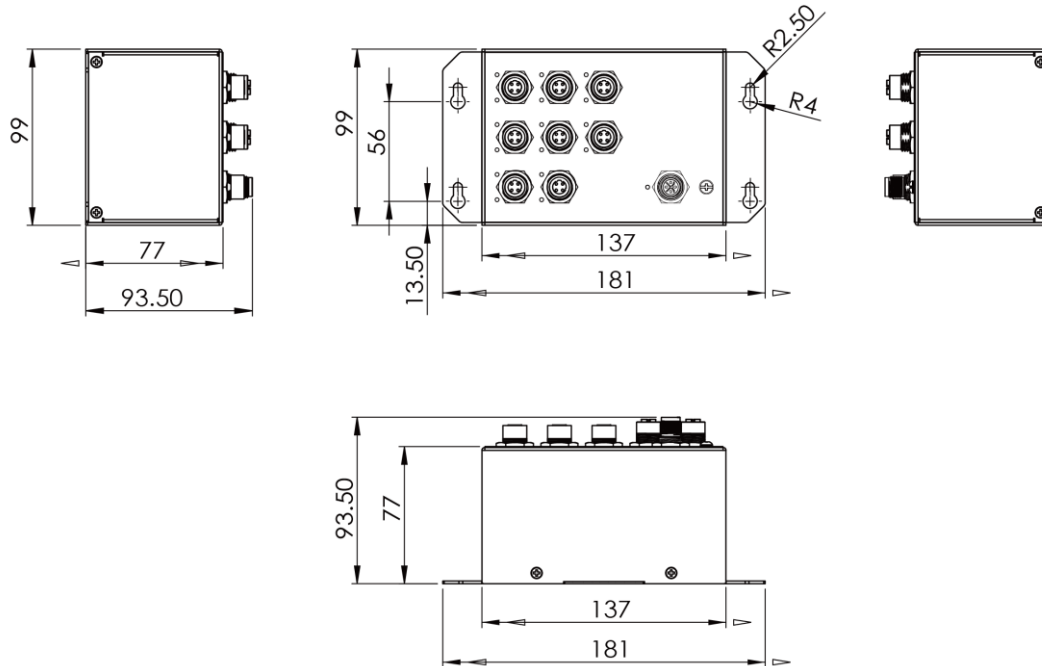

Ordering Information

ES-0800L-M12-LV-LVU-T	8 Port M12 Industrial Unmanaged Ethernet Switch - 8x 10/100T(x) M12 connector - Power Input: 24-48VDC - Operating Temperature: -40°C ~ 75°C (-40°F ~ 167°F) - Protection Class: IP40
ES-0800L-M12-LV-LVU-WT	8 Port M12 Industrial Unmanaged Ethernet Switch - 8x 10/100T(x) M12 connector - Power Input: 24-48VDC - Operating Temperature: -40°C ~ 75°C (-40°F ~ 167°F) - Protection Class: IP54
ES-0800L-M12-LV-HVU-T	8 Port M12 Industrial Unmanaged Ethernet Switch - 8x 10/100T(x) M12 connector - Power Input: 72-110VDC - Operating Temperature: -40°C ~ 75°C (-40°F ~ 167°F) - Protection Class: IP40
ES-0800L-M12-LV-HVU-WT	8 Port M12 Industrial Unmanaged Ethernet Switch - 8x 10/100T(x) M12 connector - Power Input: 72-110VDC - Operating Temperature: -40°C ~ 75°C (-40°F ~ 167°F) - Protection Class: IP54

Optional Accessories

NDR-75-24	75W Industrial DIN-Rail Power Supply, 24VDC (metal case)
NDR-75-48	75W Industrial DIN-Rail Power Supply, 48VDC (metal case)